

BIG SKY TOWER 60D - 4FT X 14FT (BACKLIT)

RESORT EXTRUSIONS

PRODUCT CODE: BIGSKYT60D4X14-LLFRM

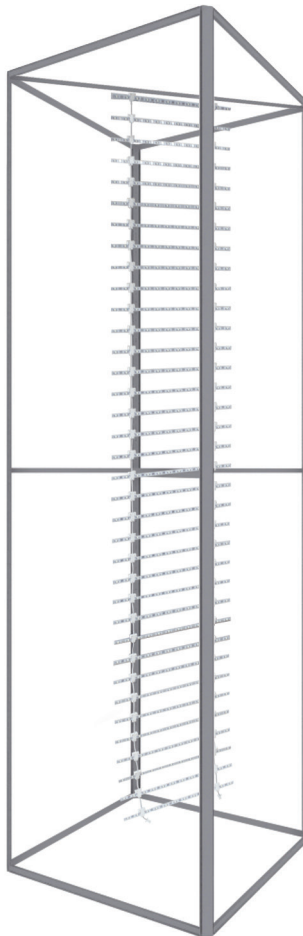

BIG SKY TOWER 60D - 4FT X 14FT (BACKLIT)

RESORT EXTRUSIONS

PRODUCT CODE: BIGSKYT60D4X14-LLFRM

SET UP INSTRUCTIONS 1/2

1. Attach Split Connectors to Side Extrusions:

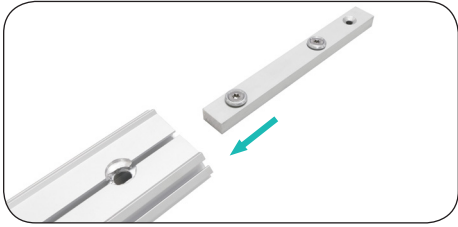

a. Remove the screw and insert split connector into one end of the extrusion. Match like colored numbers together. (e.g. 3-3, 4-4).

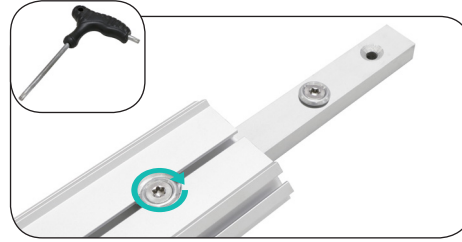

b. Tighten screw to lock it into place. Remove the remaining screw from the connector.

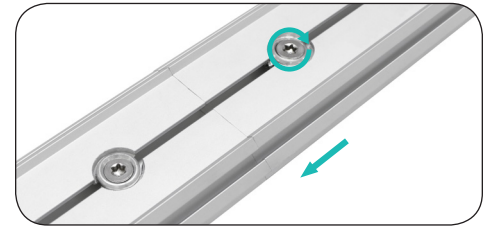

c. Then slide the other extrusion onto split connector. Make sure extrusions are flush and tighten the screw to secure connection.

2. Locate the Bottom and Side Extrusions:

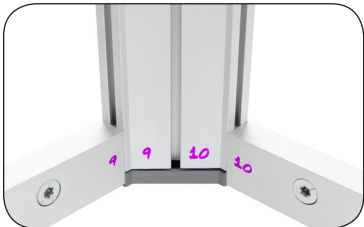

a. See colored numbers on each extrusion piece. Match like colored numbers together. (e.g. 3-3, 4-4).



b. End Lock is already attached to opposite ends of extrusion.



c. Connect horizontal extrusion to the bottom of a vertical extrusion, screw facing inward.



d. Connect bottom extrusions together and use **torx key** to tighten.

3. Locate the Top and Side Extrusions:

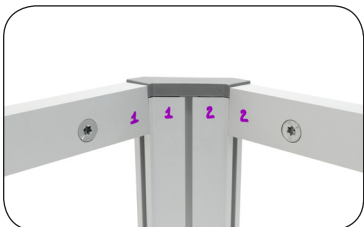

a. See colored numbers on each extrusion piece. Match like colored numbers together. (e.g. 3-3, 4-4).



b. End Lock is already attached to opposite ends of extrusion.

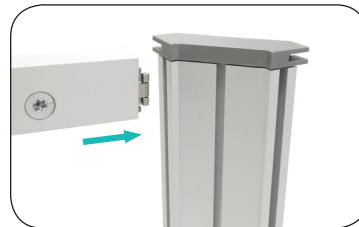

c. Connect horizontal extrusion to the top of a vertical extrusion, screw facing inward.



d. Connect the top extrusions together and use **torx key** to tighten.

4. Attach Light Hooks:

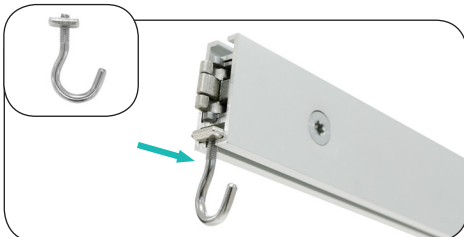

a. Eye Hooks: Insert light hooks into the groove in one end of the extrusion.

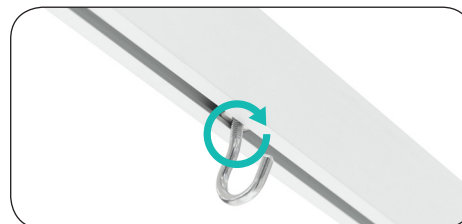

b. Slide the light hooks into the groove and place them in the center. Tighten Hook.

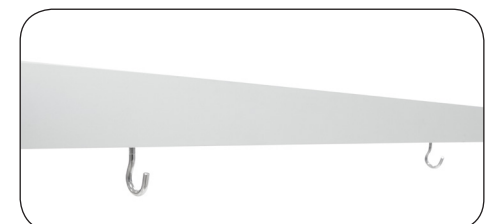

c. Make sure light hooks are placed far apart for hooking the LED Ladder Lights.

BIG SKY TOWER 60D - 4FT X 14FT (BACKLIT)

RESORT EXTRUSIONS

PRODUCT CODE: BIGSKYT60D4X14-LLFRM

SET UP INSTRUCTIONS 2/2

5. Hook Ladder Lights:

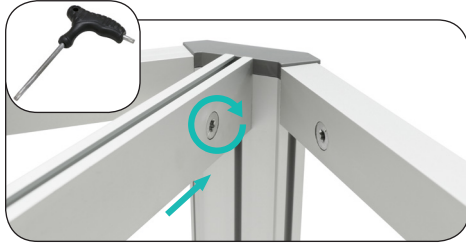

a. Place extrusion with the light hooks on top of the extrusion and connect together.



b. Hang ladder LED lights on hooks and drape them down inside the wire.

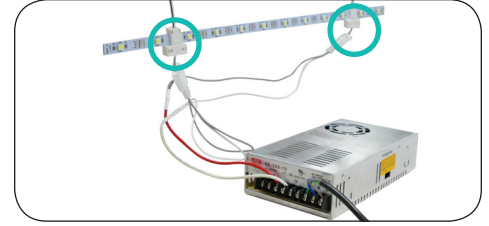

c. The transformer comes pre-wired. Connect the wiring from transformer to the 2 plugs at the bottom of the ladder lights.

6. Attach Support Strut to Frame:

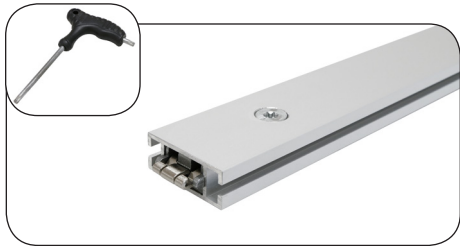

a. End Lock is already attached to opposite ends of Support Strut.

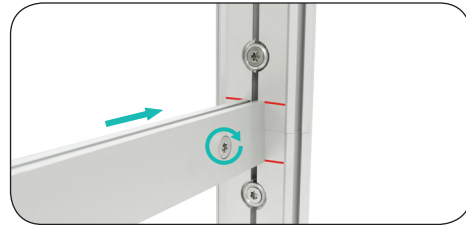

b. Align Support Struts within marked lines, and insert End Lock into top and bottom grooves of frame.

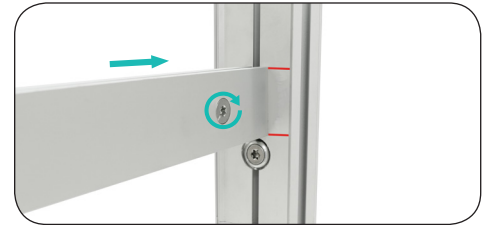

c. Add a second support strut to align marked lines and tighten screws with **torx key** to secure connection.

NOTE: Support Struts are installed between the gaps of each Ladder Lights.